

## RESETTING THE SEARCH PROCESS

### «Init Process» function:

Attention this function can modify the initial setting of the search box.

This function allows the antenna to do a search cycle from the lowest point to determine the correct elevation.

The value found is then stored in memory and assigned to all the satellites. To start this cycle, press the SEARCH key for 10 seconds.

This cycle is materialized by a series of continuous BIPs during the search.

(\*) This function is a safety device that relies on detecting the rise of the battery voltage. It may not be compatible with all types of vehicles. It will be necessary to carry out tests prior to the activation of this function.

The manufacturer can not in any case be responsible for damage caused by the non-withdrawal of the antenna due to a malfunction related to the use of this function.

The manufacturer could in no way be held responsible for a change in satellite frequencies.

## FREQUENCIES CHANGE :

Follow the instructions on our website : [www.zen-rad.com](http://www.zen-rad.com)

The manufacturer could in no way be held responsible for a change in satellite frequencies.



**CAUTION :** The positioner and the antenna are matched and should in no case be used separately under penalty of malfunction.

«S =» values are written on the back of the Search Box as well as on the basis of the antenna.

For proper operation of the automatic antenna, these values must be identical.



## POSITIONNEUR Automatic Digital Search Box (ADSB) version 8SAT

ATTENTION : TO READ BEFORE INSTALLATION



### IMPORTANT WARNINGS :



Do not turn on the Search Box without first checking the wiring.



Attention in case of exchange or post equipment, think well check the compatibility of the Search Box with your antenna. (see table on the back)  
If in doubt, contact us.

### CONNECTIONS :

The main unit must be mounted in a ventilated compartment. The connections will be :

- 12V continuous power supply
  - a red / black cable to connect to the 12 V power supply (6A) .  
(Red = + , black = -)
- The 12V receiver power supply (optional) connected to the «DC OUT» terminal + and -
- The outdoor antenna,  
Connect :
  - The gray cable to the «motor» connector
  - the black coaxial cable in the «ANT IN» slot
- Le satellite receiver must be connected to the «ANT LOOP OUT» output  
Attention: any reversal of connections can cause irreversible damage to the search box
- The «+ after ignition» (D +) of the vehicle must be connected to the terminal (Fig. 2).  
This connection allows the automatic folding of the antenna when starting the vehicle

## FRONT ADSB

Fig. 1

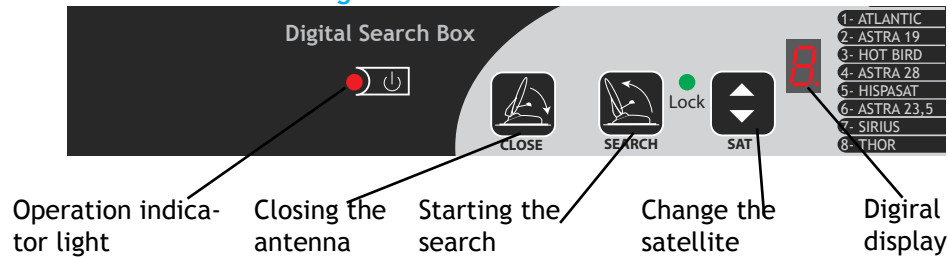

## Connection diagram

Fig. 2

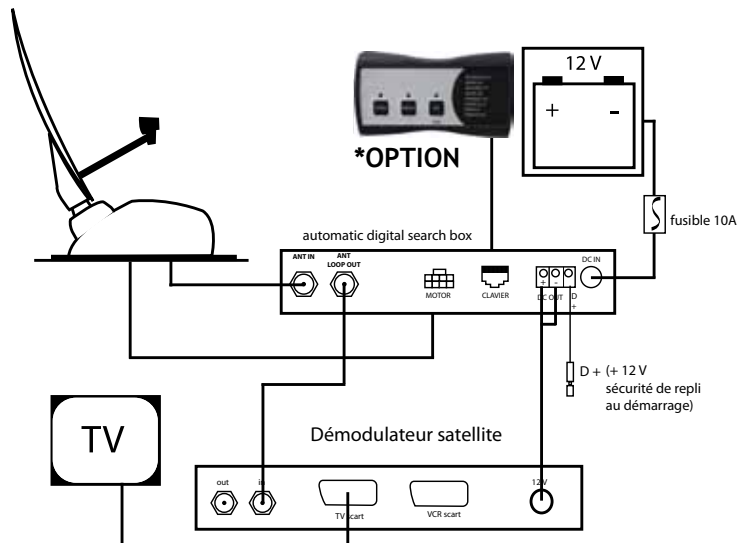

**Important:** The 12 V power supply must be protected by a 10A fuse.  
Be sure to respect the + and - polarities



**ANT IN :** to the outdoor antenna  
**ANT LOOP OUT :** to the satellite receiver



**It is strongly discouraged to change the length of the coaxial cable. If the «F» connector is disassembled, it must be reassembled as follows:**

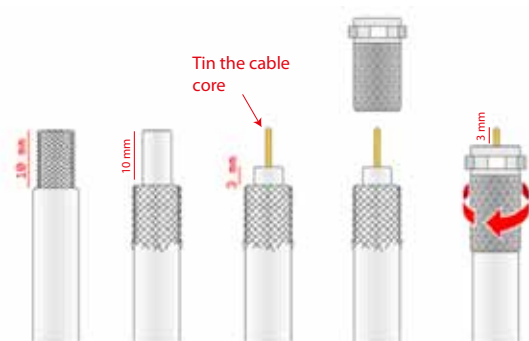

## OPERATION

The Automatic Digital Search Box (ADSB) positioner is responsible for satellite search. The automation manages the elevation then the search and the folding of the antenna.

## USE

After connecting the different elements, turn on the power. The casing is on, the red light flashes steadily.

## SEARCH

- 1) Press the search button (Fig 1).
- 2) The antenna unfolds and begins its search. The RED LED flashes steadily (during the entire research phase)
- 3) The satellite is marked, the RED LED and the GREEN «Lock» LED light up permanently.

An audible signal (double beep) confirms the correct positioning of the dish.

- 4) A long beep and a flashing green light indicate imperfect positioning.

A second action on the SEARCH button allows you to refine the positioning.

- 5) The installation is operational.

- 6) Start the satellite receiver.

These two lights remain on until the antenna is folded.

Note: The automatic management of the feed passage does not require to turn off the receiver systematically during the research phase.

## CLOSING THE ANTENNA

- 1) Press the close button (Fig. 1).
- 2) The antenna folds. The GREEN LED goes off, the RED LED flashes steadily (during the entire folding phase)
- 3) The operation is complete, the red light flashes steadily.
- 4) A second beep after about 1 minute indicates that the positioner is in standby.

The positioner has a «Low Batt.» Indicator, indicating that the supply voltage is insufficient for proper operation of the antenna. This indicator corresponds to the point of the display. In case this indicator comes on, check the power wiring and the battery charge and condition.